



ZigBee Slide Dimmer Switch Manual

<http://www.livolo.com>

Special Notes

1. Be sure to turn off the power before installation.
2. Wiring should be done in strict accordance to the wiring diagrams.
3. The total current on the switch must not exceed 2A.
4. The distance between the mounting screw holes is 60mm, and the diameter of mounting box should be at least 72mm, and the depth of mounting box is 65mm.

Installation Diagram

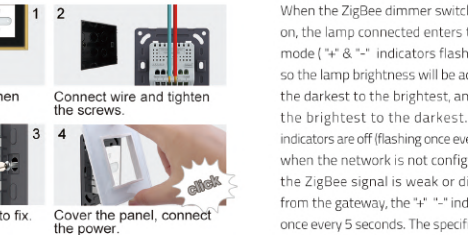

Function Introductions

When the ZigBee dimmer switch is powered on, the lamp connected enters the adaptive mode ("+" & "-" indicators flash alternately), so the lamp brightness will be adjusted from the darkest to the brightest, and then from the brightest to the darkest. The "+" "-" indicators are off (flashing once every 5 seconds when the network is not configured). When the ZigBee signal is weak or disconnected from the gateway, the "+" "-" indicators flash once every 5 seconds. The specific operations

are as follows:

1. Sliding touch: touch "+" button to increase the lamp brightness by one level, up to 7 levels; touch "-" to decrease the brightness by one level until the lamp is off; slide from "-" to "+", make sure that the sliding distance is greater than the middle of the panel, and increase the brightness in turn. When the brightness reaches the maximum, the indicators will flash to indicate; slide from

"+" to "-"

2. The touch button has on/off function, which can memorize the brightness of the lamp (the brightness of the lamp depends on the brightness after the last adjustment).

"+" to "-"

1. Sliding touch: touch "+" button to increase the lamp brightness by one level, up to 7 levels; touch "-" to decrease the brightness by one level until the lamp is off; slide from "-" to "+", make sure that the sliding distance is greater than the middle of the panel, and increase the brightness in turn. When the brightness reaches the maximum, the indicators will flash to indicate; slide from

"+" to "-"

2. The touch button has on/off function, which can memorize the brightness of the lamp (the brightness of the lamp depends on the brightness after the last adjustment).

Wiring Instructions

of One Way Switch:

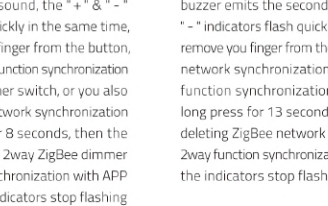

Two Way Function Instruction

Press the button for 5 seconds, when the buzzer emits a beep sound, the "+" & "-" indicators will flash quickly in the same time, and then remove your finger from the button, you can start the 2way function synchronization for 2way ZigBee dimmer switch, or you also can choose to start network synchronization with APP; if press for 8 seconds, then the synchronization of the 2way ZigBee dimmer switch or network synchronization with APP will be canceled, the indicators stop flashing quickly.

The Wiring Diagram

of Two Way Switch (Intermediate Switch):

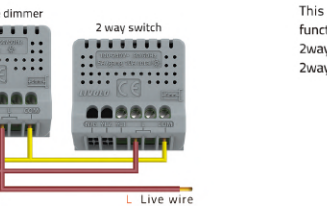

*Note:

This product is limited to realize the 2way function with normal 2way switch products, 2way ZigBee dimmer switch can't work with 2way ZigBee dimmer switch.

ZigBee Switch and gateway synchronization

Scan the QR code to download the LIVOLO APP



ANDROID APP
DOWNLOAD



IOS APP
DOWNLOAD

Product Specifications

No.	Technical Parameters	Requirements
1	Dimension	45.1mm*45.1mm*42.6mm
2	Voltage	100~240V~ 50/60Hz
3	Status indication	LED light + buzzer
4	Load power	Total current on the switch must not exceed 2A
5	Operation environment	-10°C - + 40°C
6	ZigBee wireless communication protocol	ZigBee ZHA

No.	Technical Parameters	Requirements
7	Two way function	✓
8	Flame retardant shell	✓
9	Longevity	30,000 times operation
10	Minimum load	10W (Dimmable lamps)

Switch Network Synchronization

Step 1:

Please complete the gateway network configuration work before ZigBee dimmer switch's network configuration work. For details about the gateway network configuration method, please refer to the gateway manual.

Step 2:

Open the LIVOLO APP on the "Device" page, click the "+" button on the top right corner to select the correct "Dimmer" button according to the gang number of

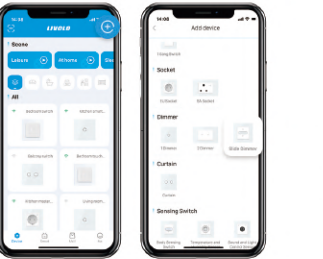

Step 3:

your ZigBee dimmer switch. According to the APP guide, press and hold the switch button for 5 seconds, when the buzzer emits a beep sound, the "+" & "-" indicators flash, click "Next" on the APP, wait until the pairing progress bar reaches 100% and click "Finished" after completing the naming then the dimmer switch pairing succeeded.

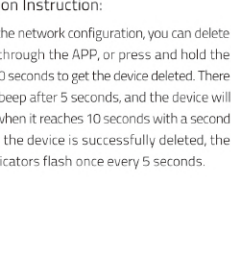
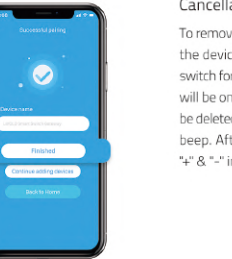
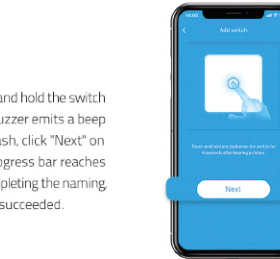

Cancellation Instruction:

To remove the network configuration, you can delete the device through the APP, or press and hold the switch for 10 seconds to get the device deleted. There will be one beep after 5 seconds, and the device will be deleted when it reaches 10 seconds with a second beep. After the device is successfully deleted, the "+" & "-" indicators flash once every 5 seconds.

Remark

If the switch doesn't work well, please turn off the power for 1 minute, and then turn it on again.

Product Size

C9:

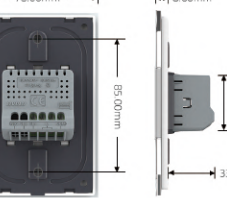

A8:

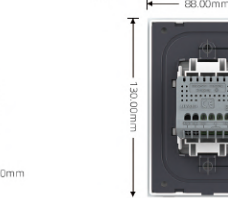

B6:

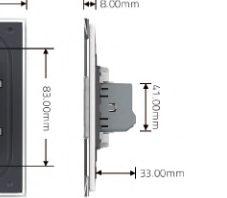

C7:

