

**LIVOLO**  
LIVE ON LOVE

## ZigBee Touch Function Model Instruction

<http://www.livolo.com>

### Installation Considerations

1. Live installation strictly prohibit.
2. Must be wiring according to wiring requirements.
3. The Max current is no more than 5A each gang (dimmer switch no more than 1A).
4. The size of the installation screw hole is 60mm, and the diameter of mounting box should be at least 72mm, and the depth of mounting box is 65mm.

### Installation instructions:



Open the package then take out product.

Connect wire and tighten the screws.



Use the two screws to fix.

Cover the panel, connect the power.

### Basic Function

Touch the switch, when lamp is on (backlight is red), when it is off (backlight is blue). When the ZigBee signal is weak or disconnected from the gateway red indicator flashes every 3s. For example when the switch is going on, red light is always on and switches to blue every 3s. When the switch is going off, the blue light is always on and switches to red every 3s.

Note:

If one gang of a touch switch doesn't have any

lamps connected, it is normal for other gangs with lamps connected to flash briefly.

Function model



Glass panel



### Wiring Instructions

of One Way Switch:

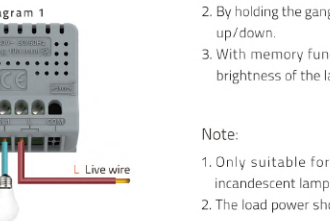

### Dimmer Switch Instruction:

1. Touch the gang briefly to switch the lamp on/off.
2. By holding the gang, the lamp will gradually dim up/down.
3. With memory function, it will remember the brightness of the last operation.

Note:

1. Only suitable for the dimmable lamp, like incandescent lamps or dimmable spotlights.
2. The load power should be less than 220W (1A).

### Two Way Switch

Synchronizing instructions:

- Step 1: Hold a gang of the switch 5s, let go when you hear a "Di" sound or if the backlight flashes, release your finger.
- Step 2: Touch the other switch, when the backlight flashes, it means the synchronization was successfully completed.

Cancel synchronization instruction:

Hold the gang of the switch 10s.

### The Wiring Diagram

of Two Way Switch (Intermediate Switch):

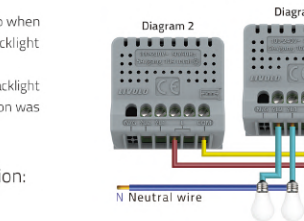

### Regular Switch Specifications

Note:

1. When one two way switch connect with others, all switches should connect to the live line.
2. Lamp can connect with any wire on the switch like L1/L2.
3. All COM ports should be connected together with others.

No.	Technical index	Requirements
1	Size	45.1mm*45.1mm*42.6mm (Hole-cut glass version) 46.5mm*46.5mm*36.75mm (Full glass version)
2	Voltage	100-240V~ 50/60Hz
3	Status indicator	Two-color LED light + buzzer
4	Max electrical current	max 5A/gang no more than 10A total
5	Operation environment	-10°C - +40°C

No.	Technical index	Requirements
6	Zigbee communication protocol	Zigbee ZHA
7	Two way function	✓
8	Inflaming retarding shell	✓
9	Longevity	30,000 times
10	Min load	5W

## Dimmer Switch Specifications

No.	Technical index	Requirements
1	Size	45.1mm*45.1mm*42.6mm (Hole-cut glass version) 46.5mm*46.5mm*36.75mm (Full glass version)
2	Voltage	100-240V~ 50/60Hz
3	Status indicator	Two-color LED light + buzzer
4	Max electrical current	No more than 2A total
5	Operation environment	-10°C - + 40°C

## ZigBee Switch and gateway synchronization

Scan the QR code to download the LIVOLO APP



ANDROID APP  
DOWNLOAD



IOS APP  
DOWNLOAD

## Description of Zigbee Pairing:

Step 1:

Please complete the gateway distribution network work before switch configuration, the details of the gateway distribution method, please refer to the gateway manual.

Step 2:

Open the livolo APP and click the "Device" icon, click on the "+" button in the upper right corner. Select the "Touch Switch" device according to the

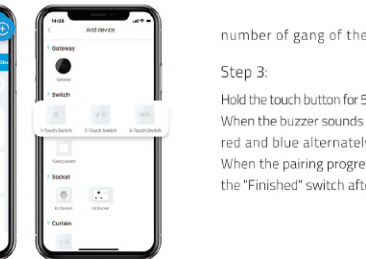

Step 3:

Hold the touch button for 5S according to app guidance. When the buzzer sounds a "Di", the indicator flashes red and blue alternately. Click the button "next" When the pairing progress bar reaches 100%, click the "Finished" switch after the naming is complete.

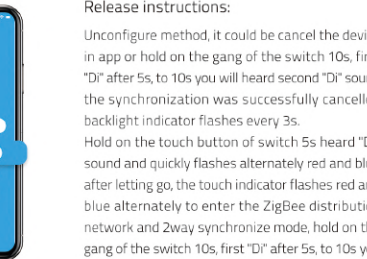

Release instructions:

Unconfigure method, it could be cancel the device in app or hold on the gang of the switch 10s, first "Di" after 5s, to 10s you will heard second "Di" sound the synchronization was successfully cancelled, backlight indicator flashes every 3s.

Hold on the touch button of switch 5s heard "Di" sound and quickly flashes alternately red and blue, after letting go, the touch indicator flashes red and blue alternately to enter the ZigBee distribution network and 2way synchronize mode, hold on the gang of the switch 10s, first "Di" after 5s, to 10s you

will heard second "Di" sound Cancel synchronizing,

if you keep hold the button 13s when you let go, you cancel the unpairing. The indicator light is always on after successful network configuration.

## Precautions Notes

If the switch doesn't work well, please switch off the power for 1 minutes then switch it on again.

## Range of Application:

