



RF Curtain Switch Touch Module (2021)

<http://www.livolo.com>

Installation Precautions

1. Don't install with electrical power.
2. Must follow the wiring diagrams.
3. The load of switch shall not over 3A.
4. The switch's fixing centre is 60mm, the diameter and the depth of mounting box should be at least 72mm and 65mm.
5. If the first touch test is without the glass panel, please cut off the electrical power, cover the button plate with glass panel, then recover the power supply.

Installation Instruction

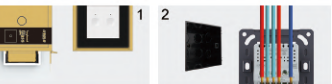

1
Open the package then take out product.



2
Connect wire and tighten the screws.



3
Use the two screws to fix.



4
Cover the panel, connect the power.

Basic Function Introductions

1. The left touch button is for motor's forward rotation, the right button is for the reverse. When the touch button's indicator is red, it means the motor is driving; touch the button again, the indicator turns to blue, the motor stops forwarding and starts to reverse. While the curtain motor is driving forward, touching another button can stop forward and begin reverse, and vice versa.
2. If want to exchange 2 buttons' functions because of the wrong wiring or doing it out of habit. Then you can press both of 2 buttons together for 5

seconds and when you hear the beep sound, release your fingers, the function exchange is done.

3. The default time of this switch for supporting curtain motor's forward or reverse is 60s. If the curtain doesn't fully open or close after 60s, press 2 buttons together for 10s. When you hear two 5-seconds beep sounds, release your finger and the time delay is done. The default time would be delayed to 75s. This procedure can be maximumly repeated for 4 times. Each time will

add 15 seconds. 120s is the maximum default time can be delayed. The fifth time will recover to 60s.

Small panel type



Full glass panel type



Specification

No.	Item	Specification
1	Dimension	45.1mm*45.1mm*42.6mm (Small Panel type) 46.5mm*46.5mm*36.75mm (Full Glass Panel Type)
2	Voltage	Live & neutral wire power supply 100Vac~240Vac 50/60Hz
3	Maximum Load	3A
4	Status Indication	Dual Color LED Indicator, Buzzer
5	Operation Environment	-10°C - +40°C

No.	Item	Specification
6	Lifespan	30,000 Times Operation
7	Wireless Protocol	RF (Radio Frequency)
8	Fire-Retardant Shell	✓
9	Shell Surface	Smooth Surface, No Shrinkage, No Weld Mark
10	2 Way Function	X

The Small Remote

RF Pairing:

Step 1: Press any switch's button for 5s;

Step 2: Loose finger when hear beep sound;

Step 3: Press any button on the remote controller;

Step 4: When hear beep sound from switch again, the pairing finished.



A=1 Gang

B=2 Gang

C=3 Gang

D=All off

How to unpair:

Repeat the above RF pairing instructions. Or press any switch's button for 10s, then you can hear two 5s beep sounds. The device will be deleted successfully after the second beep sound.

Note:

If the curtain is open when you press the "Sleeping Mode" button while using the remote controller or it's out of your habit, you can press the controller's

2 buttons for 5s, release your fingers after a beep sound, then the exchange of buttons' function is done.

Remark

If curtain switch can't be operated normally, please cut off the power supply and recover it after 1 min.

Wiring Diagram

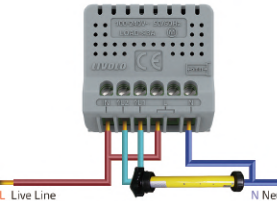

Product Dimension

